

SHERA™

build better, live better



***SHERA* TILE/ MARBLE FIXING MANUAL**

In the present scenario, tiles/ marbles have become an integral part of surface design, having a huge impact on indoor and outdoor finishes on walls, panelling, etc. The tile industry in India continues to innovate, incorporating new-age technology and design trends to meet end users' requirements. As per current trends, users look forward to enhancing the beauty of walls by the application of multiple decorative products available in the market. This tile/ marble is most commonly used to enhance the beauty of the wall or panelling application. While application of tiles/ marbles are applied on SHERA fibre cement boards, the SHERA tile/marble fixing manual will provide its users a comprehensive guidance on installing tiles/ marbles on board surfaces, ensuring a durable finish that justifies the beauty of tiles/marbles.

Content

01 Introduction

02 Selection of SHERA Board Thickness

03 Selection of Tile Adhesive

04 List of Tools and Accessories

05 Framing Requirements

06 Tile Fixing Procedure

Introduction

SHERA boards are type A strong, highly versatile & durable boards which are suitable for multiple applications like dry wall partition, panelling, etc, both in dry as well as wet areas. Its exceptional strength and durability enable users to install tiles/ marbles/ wallpaper, etc, using appropriate tile adhesive without any hindrances. The selection of an appropriate adhesive for pasting cladding material on SHERA board plays a very vital role, and proper care should be taken while selecting the adhesive for such an application. SHERA board comes with excellent pull-out strength which resists cladding load when pasted with adhesive, ensuring a durable and easy workability solution for tile/ marble cladding in wall partition & panelling.

Selection of SHERA Board Thickness

Depending on the selection of tile or marble on the application, it is essential to select the correct thickness of SHERA board. It is also equally important to understand details of applications like wall partition, panelling, along with the type of application, whether an Interior or Exterior application.

The below-mentioned chart should be referred for the selection of the recommended thickness of SHERA board. Permissible wet cladding load will be the deciding factor for the selection of the thickness of the board.

6mm Thick SHERA Board	30 kg / sqmtr	Dry / Decorative Area
8mm Thick SHERA Board	40 kg / sqmtr	Dry / Decorative Area
10mm / 12mm Thick SHERA Board	50 kg / sqmtr	Wet / Traffic Area

Please note :

- The above mentioned loading criteria are calculated considering the support frame spacing not exceeding 600mm c/c in the main direction.
- It is advisable to fix SHERA board's rough surface on the back side facing with the tile application surface to enhance grip with the cement glue.

Selection of Tile Adhesive

After the selection of the SHERA board and preferred tiles or marbles, one should select the correct tile pasting adhesive to fix tiles or marbles on SHERA board surface. Many renowned brands are manufacturing good-quality tile adhesives that are available in India, which can be used to paste the tiles/ marbles on the SHERA board. As per the suggestions given by the adhesive manufacturer, one can select the appropriate adhesive based on the points as mentioned below

- Type of Tile/ marble
- Internal or External Application
- Weight carrying capacity of adhesive
- Type of application like floor, wall, or other surface application
- Drying Time
- Cost and availability

The selection of the correct adhesive plays a vital role in tile application, which delivers optimal results and extended lifespan.



List of Tools & Accessories

With the help of correct tools and equipment's one can achieve maximum efficiency. The tools required for the tile/ marble application process are as listed below

Circular Saw



Screw machine



Spinner



Tube Level



Notch Trowel



Rubber mallet



Frame Arrangement

SHERA Board is installed by the dry cladding process, which requires a framework for support. The user needs to make sure that the correct selection of frame material and frame spacing is followed on site for the SHERA boards installation. Frame spacing, considering the application area, should be adjusted based on project-specific requirements. Ensure that the boards are fixed properly in place to provide a firm and steady substrate.

- **Regular areas** of application mainly for decorative applications - should have a supporting steel frame installed with a maximum spacing of **600 x 600 mm**.
- **High traffic area** with consistent usage area (cause of deflections) - should have a supporting steel frame installed with the maximum spacing of **300 x 300 mm**.

Please refer board fixing manual for detailed frame and board fixing methodology.

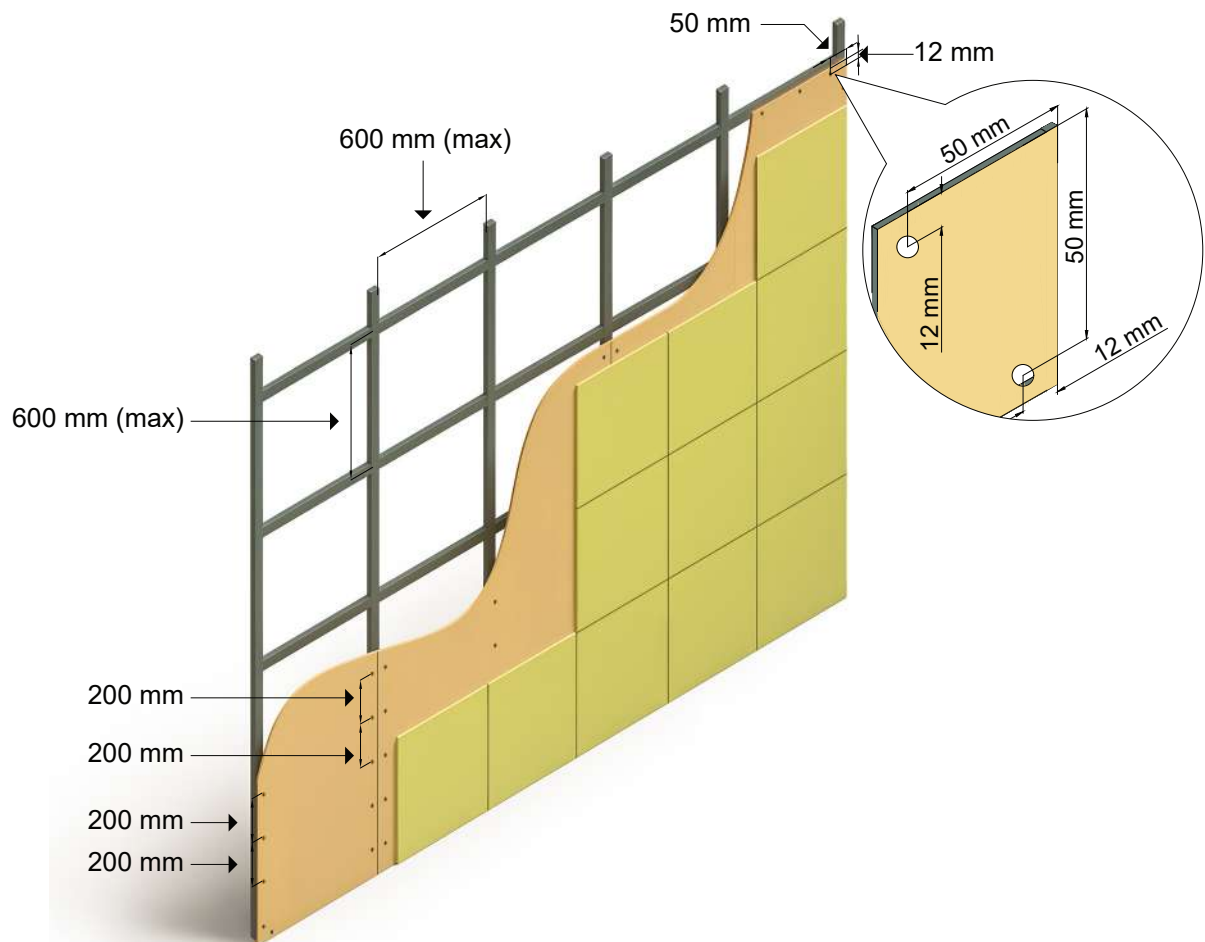

Tile Application Process

Once the appropriate SHERA board and tile adhesive is selected as per above mentioned criteria, the user needs to follow the correct installation process to make sure the application is done in the correct way.



01

Please make sure that the application surface is flat and all screws used for fixing SHERA board are countersunk by 1mm to 2mm for smooth application of tile adhesive paste on throughout surface area.

02

Please check that the SHERA board surface is thoroughly cleaned and free from dust particles or any other foreign material.



03

Select the appropriate tile adhesive depending upon the criteria mentioned above as per the adhesive manufacturer.



04

Depending upon the recommendation of the tile manufacturer, please check if an adhesive primer coat is required before tile adhesive paste application. Please discuss with the adhesive manufacturer whether primer is required as per the standard process. If required, please apply primer using a paint brush/ roller on the entire surface of the substrate on which tiles or marbles are to be pasted.

05

To achieve optimal results, carefully follow the adhesive mixing instructions provided by the manufacturer. Whether the adhesive is premixed or requires mixing in specific ratios, kindly ensure that the mixing process is done accurately. Use a stirrer to achieve a smooth & uniform paste.

Proper mixing confirms that the adhesive is fully hydrated, allowing the polymers & other components to fully activate & form a strong bond with the tile & substrate. It helps to maintain a consistent texture.

Before doing every application, please stir the tile adhesive properly.



06

Apply tile adhesive on the SHERA board surface with the help of notched trowel.

Notched trowel will help to spread the adhesive evenly while maintaining the proper bidding thickness of adhesive as per application requirement.

07

Fix tile/ marble on top of tile adhesive by checking it's positioned correctly before the adhesive dry up.

If necessary, lightly tap the tiles into position with rubber mallet. This will help to release entrapped air below the tiles/marbles. This process ensures proper bonding and adhesion between tile and substrate.





08

Allow tile adhesive to dry completely before proceeding with grouting the tile joints.

09

Once the application is completely dry, it can be followed by the grouting process. To remove any grout or tile adhesive that is left on the tiles, it can be cleaned using a moist sponge.



SHERA™

build better, live better



 **Mahaphant India Private Limited**

WeWork Raheja Platinum, 2nd Floor, Off Andheri-Kurla Road,
Marol, Andheri East, Mumbai-400059

 +91 80974 99099 |  india_sales@shera.com

Follow us on SHERA INDIA      @sheraindia |  shera.com